

NEW UNITS TO LET

5,869 to 31,454 sq ft (545 to 2,922 sq m)

A new development of industrial/warehouse units situated in a prime location on the Brimsdown Industrial Area in Enfield, North London.

www.enfieldthegrid.com



THE GRID

Enfield

ONLY
FIVE UNITS
REMAINING



LOCKFIELD AVENUE | ENFIELD | EN3 7PX





THE GRID
Enfield

A range of flexible units ideally suited for serving the North and Central London markets and the wider South East.



Enfield's strategic location with easy access to the M25 and A406, plus Central London, London airports and public transport network has attracted a diverse industrial and distribution base. It is home to over 10,000 logistics and industrial businesses employing nearly 90,000 people.



Accommodation

Unit No.	Ground Floor (sq ft)	First Floor (sq ft)	TOTAL* (sq ft)
1	LET		24,696
104	LET		15,070
90	5,278	1,243	6,521
92	5,510	1,298	6,808
94	4,750	1,119	5,869
96	4,790	1,129	5,919
98	5,128	1,209	6,337
100	LET		6,743
102	LET		7,591
TOTAL			85,554

*Areas are approximate on a GEA basis.
Units can be combined.

Planning use

B1 (c), B2 and B8 (industrial and warehouse) uses.

Terms

The units are available on new leases with full terms upon application.

General specification

- 8.4m clear internal height
- Full height electric loading doors
- 37.5kN per sq m floor loading
- Fully fitted first floor offices
- Gated secure estate
- 3 phase power supply
- Potential for mezzanine floors

Green credentials



The scheme employs the latest environmentally friendly technologies to reduce the costs of occupation and will ensure a minimum 35% decrease in CO2 emissions over 2010 Buildings Regulations. The units achieve a BREEAM rating of "Excellent". As a result occupation costs to the end user will be reduced.

The green initiatives include:

- Photovoltaic panels
- Low air permeability design
- Electric vehicle charging points
- 15% warehouse roof lights increasing natural lighting
- High performance insulated cladding and roof materials
- Secure cycle parking
- Air source heat pumps

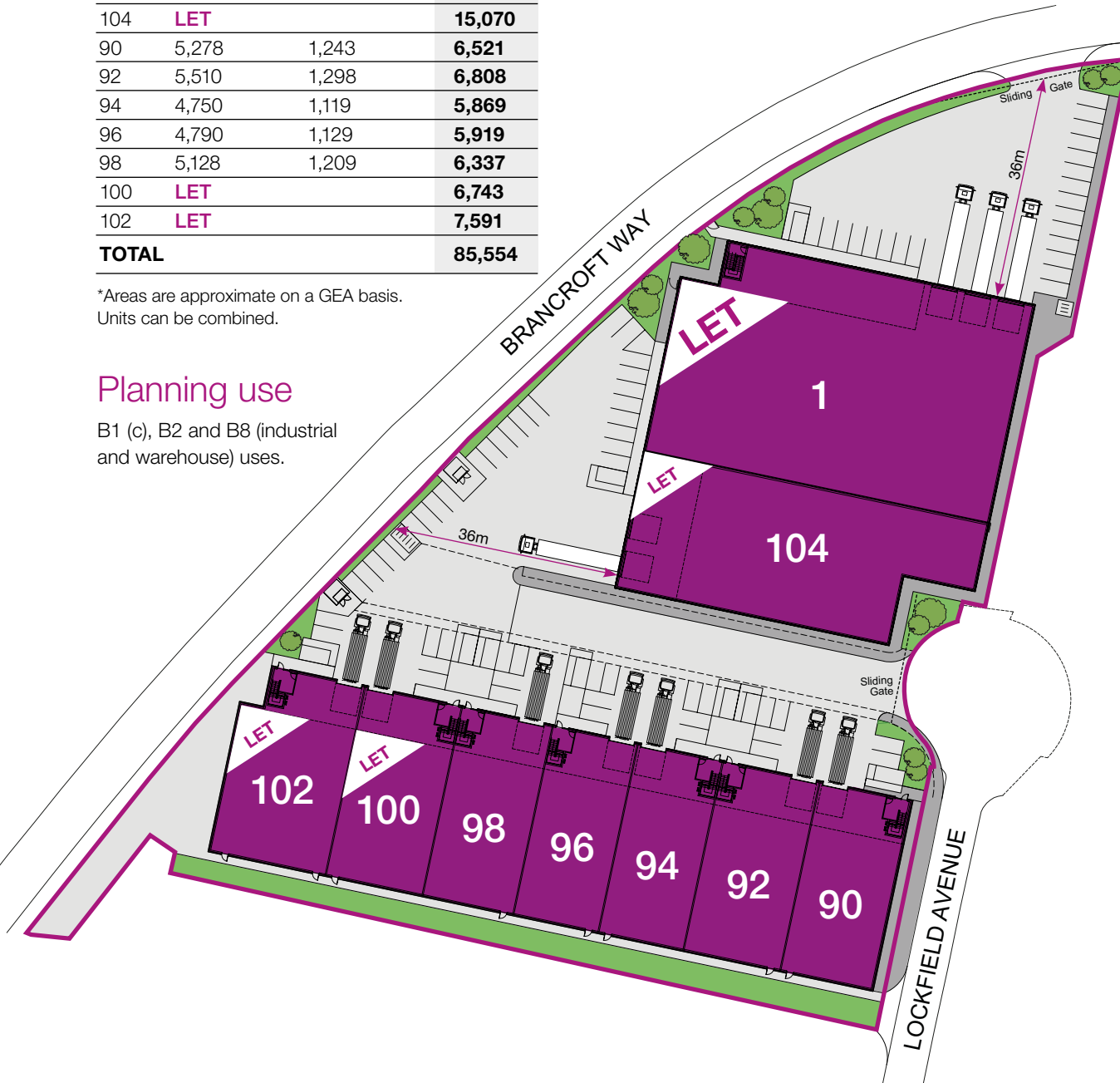



Location

Lockfield Avenue is located just off Mollison Avenue (A1055) in the heart of the Brimsdown Industrial Estate within the second largest industrial/warehouse area in London. Its position provides an ideal location for companies looking to deliver services and provide “just in time” logistical support into the capital.

The local road network offers excellent access. The A1055 links the site to the A406 North Circular (4 miles south) and the A10 providing direct access into Central London (12 miles). The M25 (J25) is located 4 miles north and the M11 Motorway is 8 miles to the east.

The location is served by Brimsdown Rail station which is within walking distance and provides regular services into London Liverpool Street and the West End via Tottenham Hale (Victoria Line) and north to Stansted Airport.

www.enfieldthegrid.com

Travel distances

BY ROAD:

A406	4 miles/8 mins	M1 J1	12 miles/26 mins
M25 J25	4 miles/10 mins	Central London	12 miles/38 mins
M11 J4	8 miles/15 mins		

BY RAIL:

Brimsdown Stn	1.3 miles/5 mins (to London Liverpool Street: 22 mins)
Enfield Town	3 miles/8 mins (to London Liverpool Street: 33 mins)
Tottenham Hale	4.7 miles/11 mins (Victoria Line to Central London: 17 mins)

AIRPORTS:

City	15 miles/28 mins
Stansted	28 miles/39 mins
Heathrow	43 miles/53 mins

More information available through the joint selling agents:

savills.co.uk **savills**
0207 409 8817

Jack Booth **Christian Wright**
 jbooth@savills.com cwright@savills.com
 07807 999 558 07870 186 483

GLENNY
020 8367 2334
 GLENNY.CO.UK

Ivan Scott **Jeffrey Prempeh**
 i.scott@glenny.co.uk j.prempeh@glenny.co.uk
 07342 880 685 07768 236 337

BNP PARIBAS REAL ESTATE
020 7338 4000
 realestate.bnpparibas.co.uk

Nick Hardie
 nick.hardie@realestate.bnpparibas
 07827 315 851

James Coggle
 james.coggle@realestate.bnpparibas
 07469 403 283

A development by:

